

SUMMARY OF QUANTITIES
(PUBLIC)

ITEM #	ITEM	UNIT	QUANTITY	AS-BUILT
1.	6" WATERLINE (C-900)	L.F.	3	
2.	6" X 8" TAPPING SLEEVE (M.J.)	EA	1	
3.	6" TAPPING VALVE & BOX	EA	1	
4.	SAND BACKFILL	CY	1	
5.	TESTING & DISINFECTING	L.S.	1	
6.				

TSD / RLM
9/22/25
NO COMMENTS

PROJECT NO. WF-2025-00055

WATER PLANS

TO SERVE

WESTMOORE HIGH SCHOOL

LOCATION DESCRIPTION

A PART OF THE NE/4, SEC. 17, T10N, R3W, I.M., OKLAHOMA CITY,
CLEVELAND COUNTY, OKLAHOMA



The City of
OKLAHOMA CITY
Utilities Engineering
Private Development Division

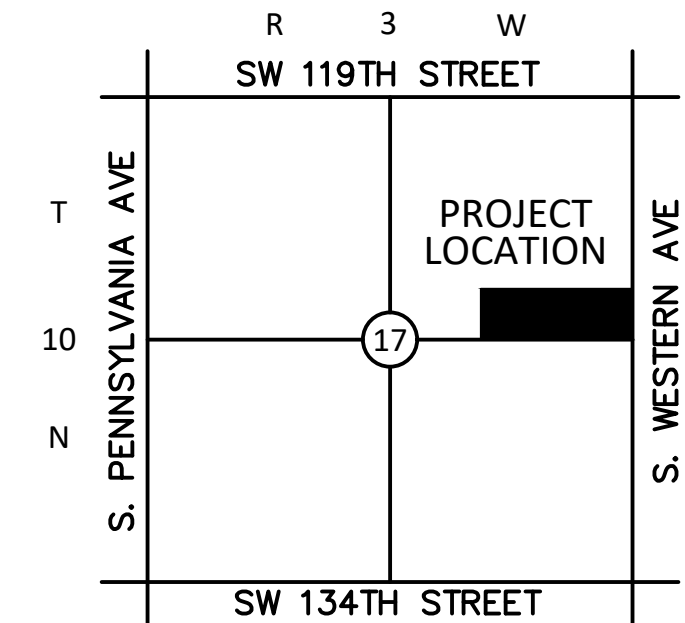

NOT TO SCALE

SHEET INDEX

SHEET NO.	DESCRIPTION
WF0.00	COVER SHEET
C2.00	UTILITY PLAN
WF1.00	FIRELINE '1' PLAN & PROFILE
C3.00	EROSION CONTROL PLAN
C3.01	EROSION CONTROL DETAILS

Review and approval of construction plans for the installation of public water and wastewater facilities, mains, and appurtenances by Oklahoma City is only for conformance with Oklahoma City design requirements or standards. Oklahoma City takes no responsibility for any errors or omissions within the plans or for construction in conformance with the plans and easements. The Professional Engineer that sealed the approved plans and specifications must prepare and submit any revisions or modifications to Oklahoma City for review and approval. The Developer and/or their representative is responsible for ensuring that construction is completed in conformance with the approved plans and specifications.

ONE CALL UTILITY LOCATION NUMBER

840-5032
1-800-522-6543

This number is to be used for information on the location of all underground utilities. Contact this number and other numbers specified in the plans prior to any excavation.



PREPARED BY: Derek Harris (OK P.E. 35342) (405) 778-3385 Date: 03.31.25

CONSTRUCTION MUST BEGIN WITHIN ONE (1) YEAR FROM THE DATE OF APPROVAL, OR THAT APPROVAL IS WITHDRAWN.

**DEPARTMENT OF UTILITIES
ENGINEERING PRIVATE
DEVELOPMENT DIVISION**

REGISTERED PROFESSIONAL ENGINEER
DATE: 09.19.25

Checked by: [Signature] Date: 10/06/25
Checked by: [Signature] Date: 10/06/25
Checked by: [Signature] Date: 10/06/25



**DEPARTMENT OF PUBLIC WORKS
ENGINEERING DIVISION**

APPROVED: [Signature] Date: 10/6/25
DEBORAH K MILLER, P.E., DIRECTOR
PUBLIC WORKS / CITY ENGINEER

WESTMOORE HIGH SCHOOL

WF-2025-00055

WATER GENERAL NOTES

- ALL CONSTRUCTION SHALL CONFORM TO CURRENT OKLAHOMA CITY STANDARD SPECIFICATIONS FOR CONSTRUCTION OF PUBLIC IMPROVEMENTS AND SHALL BE UNDER STRICT SUPERVISION OF THE CITY ENGINEER OF THE CITY OF OKLAHOMA CITY.
- ALL CONSTRUCTION SHALL CONFORM TO TITLE 252 OKLAHOMA ADMINISTRATIVE CODES.
- SEPARATION OF WATER MAINS AND SEWER SHALL BE IN ACCORDANCE TO ODEQ 252.626-19-2-(h).
- PRESSURE AND LEAKAGE TESTING SHALL BE IN ACCORDANCE TO ODEQ 252.626-19-2-(e).
- DISINFECTATION AND TESTING SHALL BE IN ACCORDANCE TO ODEQ 252.626-19-2-(f).
- ALL WORK NOT CLASSIFIED AS A PAY ITEM SHALL BE CONSIDERED INCIDENTAL CONSTRUCTION. COST OF WHICH SHOULD BE INCLUDED IN THE COST OF OTHER PAY ITEMS.
- THE CONTRACTOR SHALL BE RESPONSIBLE FOR REPLACING ALL LANDSCAPING IN AS GOOD OR BETTER CONDITION AS EXISTING LANDSCAPING.
- IN ACCORDANCE WITH ODEQ REGULATIONS, THE CITY PROVIDES WATER AT A MINIMUM PRESSURE OF 25 psi. THE DEVELOPER IS RESPONSIBLE FOR DESIGNING AND CONSTRUCTION OF ALL FIXTURES TO PROVIDE ADEQUATE DOMESTIC AND FIRE PROTECTION UNDER MINIMUM PRESSURE CONDITIONS. THE DEVELOPER WILL BE RESPONSIBLE FOR ANY FAILURE OF DOMESTIC AND FIRE PROTECTION SYSTEMS WHICH REQUIRE WATER PRESSURE IN EXCESS OF 25 psi.
- THE CONTRACTOR SHALL FIELD VERIFY ALL EXISTING UTILITIES AND DEPTHS PRIOR TO CONSTRUCTION BY MEANS OF UTILITY SURVEY. THE CONTRACTOR SHALL BE RESPONSIBLE FOR THE REPLACEMENT OR REPAIR OF ALL PRIVATE & PUBLIC UTILITIES DAMAGED DURING CONSTRUCTION.
- ALL SERVICES ARE TO BE CONNECTED TO EXISTING METER WITH MATERIAL PER CURRENT CITY OF OKLAHOMA CITY SPECIFICATIONS FROM PROPOSED WATER MAIN.
- STANDARD DEPTH OF COVER SHALL BE A MINIMUM OF 4.0 FEET. MINIMUM DEPTH OF 5.0 FEET REQUIRE ALONG SECTION ROADS.
- ALL CROSSINGS AND PROPOSED TIE-IN LOCATIONS SHALL BE EXCAVATED AHEAD OF CONSTRUCTION TO VERIFY THE FLOWLINE OF EXISTING WATER MAINS.
- THE CONTRACTOR SHALL BE RESPONSIBLE FOR THE CONSTRUCTION STAKING. THE STAKING MUST BE DONE BY AN OKLAHOMA REGISTERED PROFESSIONAL LAND SURVEYOR WHICH WILL BE VERIFIED BY CITY INSPECTORS.
- THE AIR RELEASE AND VACUUM VALVE SHALL MEET CURRENT CITY OF OKLAHOMA CITY SPECIFICATIONS.
- HYDRANTS SHALL CONFORM TO AWWA STANDARD C502, LATEST REVISION & MEET CURRENT CITY OF OKLAHOMA CITY SPECIFICATIONS.
- ALL VERTICAL AND HORIZONTAL FITTINGS REQUIRE MECHANICAL JOINT RESTRAINTS PER CITY OF OKLAHOMA CITY SPECIFICATIONS.
- THE CONTRACTOR SHALL BE RESPONSIBLE FOR GRADING ALL DISTURBED AREAS TO DRAIN AS GOOD OR BETTER THAN EXISTING CONDITIONS.
- THE CONTRACTOR SHALL PROVIDE SEVEN (7) DAYS NOTICE TO OKLAHOMA CITY LINE MAINTENANCE DIVISION AND THE PROPERTY OWNERS PRIOR TO TAKING ANY WATER MAIN OUT OF SERVICE. THE CONTRACTOR IS NOT ALLOWED TO OPERATE ANY VALVE CONNECTED TO OKLAHOMA CITY WATER MAINS.
- WHEN PVC PIPE IS SPECIFIED AND USED ON THIS PROJECT, CONTRACTOR SHALL INSTALL ONE STRAND OF NO. 12 GAUGE COPPER TRACER WIRE ALONG TOP OF ALL PVC PIPES. BRING THE TRACER WIRE TO TOP OF GROUND AND ANCHOR AT ALL VALVES, FIRE HYDRANTS, AND OTHER APPURTENANCES.
- THE CONTRACTOR SHALL BE RESPONSIBLE FOR THE GPS "AS-BUILT" SURVEY, FOLLOWING THE INSTALLATION OF WATER MAINS, FOR EVERY 100' ALONG THE ALIGNMENT OF THE PROJECT. COORDINATES OF THE VALVES, FIRE HYDRANTS, EXISTING WATER METERS, AND SIMILAR APPURTENANCES. AN AUTOCAD DRAWING AND COORDINATE DATA SHEET SHALL BE SUBMITTED TO THE PRIVATE DEVELOPMENT DIVISION FOR APPROVAL. THIS TASK MUST BE PERFORMED BY A REGISTERED PROFESSIONAL LAND SURVEYOR. DATA SUBMITTED SHALL BE TIED TO OKLAHOMA STATE PLANE COORDINATE SYSTEM.
- WATER METERS AND FIRE HYDRANTS MUST SIT WITHIN THE ROW OR UTILITY EASEMENT LOCATED IN A GRASSY AREA OUTSIDE OF PAVING FOR SIDEWALKS, STREETS, & DRIVEWAYS.
- ON APRIL 30, 2013, THE CITY OF OKLAHOMA CITY ADOPTED A RESOLUTION ESTABLISHING A PERMANENT MANDATORY WATER CONSERVATION PROGRAM RESTRICTING WATERING TO EVERY OTHER DAY WITH PROPERTIES WITH ODD NUMBERED ADDRESSES BEING PERMITTED TO WATER ONLY ON ODD NUMBERED DAYS AND PROPERTIES WITH EVEN NUMBERED ADDRESSES BEING PERMITTED TO WATER ONLY ON EVEN NUMBERED DAYS. SHOULD CONDITIONS INCLUDING BUT NOT LIMITED TO DECREASED WATER SUPPLY STORAGE LEVELS OR DROUGHT CAUSE CONDITIONS TO DETERIORATE INCREASED WATER RESTRICTIONS MAY COME INTO EFFECT. THESE CURRENT AND FUTURE CONSERVATION REQUIREMENTS AND WATER AND WATERING RESTRICTIONS ARE APPLICABLE TO ALL PROJECTS AND CONTRACTORS JUST AS THEY ARE APPLICABLE TO OKLAHOMA CITY CITIZENS. SEE DETAILS AT: <http://www.squeezeeverydrop.com/> THE CITY OF OKLAHOMA CITY HAS ALSO ESTABLISHED A VARIANCE PROGRAM FOR IRRIGATION OF NEW LANDSCAPING. CONTRACTOR WILL BE RESPONSIBLE FOR TIMELY OBTAINING AND, IF AND AS GRANTED, FOR COMPLIANCE WITH THE VARIANCE PROGRAM REQUIREMENTS. SEE DETAILS AT: <http://www.squeezeeverydrop.com/WaterConservationProgram/VarianceProgram.aspx> FAILURE TO COMPLY WITH THE CURRENT AND FUTURE RESTRICTIONS AND REQUIREMENTS OF THE MANDATORY WATER CONSERVATION PROGRAM OR THE VARIANCE, IF AND AS GRANTED, MAY RESULT IN THE RECEIPT OF A CITATION AND/OR THE REVOCATION FOR THE VARIANCE.

- FINAL GRADING MUST BE COMPLETE PRIOR TO INSTALLATION OF WATER AND SANITARY SEWER MAINS.
- TYPE 'A' AGGREGATE BACKFILL SHALL BE PLACED IN ALL TRENCHES UP TO GROUND LEVEL WHERE LINES CROSS UNDER PROPOSED OR EXISTING PAVING. TYPE 'A' AGGREGATE BACKFILL SHALL BE COMPACTED IN ACCORDANCE WITH THE CITY OF OKLAHOMA CITY STANDARD SPECIFICATIONS. THE MAXIMUM PAY QUANTITY FOR TYPE 'A' AGGREGATE BACKFILL IS THAT QUANTITY REQUIRED TO FILL A NEAT MINIMUM WIDTH DITCH, LISTED IN THE TRENCH WIDTH DETAIL, FROM THE FLOWLINE OF THE PIPE TO THE PAVEMENT SUBGRADE ELEVATION TO 5' BACK OF CURB ON EACH SIDE OF THE STREET. ANY ADDITIONAL TYPE 'A' AGGREGATE REQUIREMENTS ARE CONSIDERED INCIDENTAL.
- THE CONTRACTOR SHALL BE RESPONSIBLE FOR THE SAFETY OF ALL UTILITIES, BOTH UNDERGROUND & OVERHEAD, EITHER PUBLIC OR PRIVATE, AS TO THEIR ACTUAL LOCATION PRIOR TO COMMENCING CONSTRUCTION.
- ANY SUBDIVISION ENTRY SIGN, MARQUEE, SIGN, FENCE, STRUCTURE, ETC. THAT WILL BE OVER ANY PROPOSED WATER AND/OR WASTEWATER MAIN. THE MAIN MUST BE STEEL ENCASED A MINIMUM OF 20 FEET AND EXTEND 5 FEET BEYOND THE EDGE OR FOOTING OF SIGN. FOR ANY EXISTING MAINS, CONCRETE ENCASE EXISTING MAINS AS REQUIRED. A REVOCABLE PERMIT IS REQUIRED TO ALLOW THESE TO BE IN THE ROW AND/OR UTILITY EASEMENT.
- ENGINEER TO PROVIDE DESIGN FOR RESTRAIN JOINT PIPE LENGTHS FOR ALL FITTINGS IN ACCORDANCE WITH THE JOINT RESTRAINT MANUFACTURER WITH A MINIMUM TEST PRESSURE OF 150 PSI.

TRAFFIC NOTES

- A WORK ZONE PERMIT MUST BE OBTAINED FROM THE TRAFFIC SERVICES DIVISION AT LEAST TWO (2) WORKING DAYS PRIOR TO THE START OF WORK AND/OR PLACING OR REMOVING ANY BARRICADES OR MODIFYING EXISTING TRAFFIC CONTROL DEVICES. APPLICATION FOR WORK ZONE PERMIT CAN BE LOCATED AT <https://access.okc.gov/aca/Default.aspx>
- THE CONTRACTOR IS RESPONSIBLE FOR THE PROMPT REPLACEMENT AND/OR REPAIR OF ALL TRAFFIC CONTROL DEVICES AND APPURTENANCES DAMAGED OR DISTURBED DUE TO CONSTRUCTION.
- THE CONTRACTOR IS RESPONSIBLE FOR THE REMOVAL OF ALL PAVEMENT MARKINGS THAT WILL BE IN CONFLICT WITH THE PROPOSED WORK.

EROSION CONTROL NOTES

- ALL LAND DISTURBING ACTIVITIES INSIDE OKC LIMITS MUST OBTAIN A LAND DISTURBING ACTIVITY PERMIT WITH STORM WATER QUALITY MANAGEMENT DIVISION. ADDITIONALLY, CONSTRUCTION ACTIVITIES THAT RESULT IN LAND DISTURBANCE EQUAL TO OR GREATER THAN ONE (1) ACRE, OR LESS THAN ONE (1) ACRE IF THEY ARE PART OF A LARGER COMMON PLAN OF DEVELOPMENT OR SALE THAT TOTALS AT LEAST ONE (1) ACRE, MUST OBTAIN AUTHORIZATION TO DISCHARGE STORMWATER UNDER THE STATE OF OKLAHOMA DEPARTMENT OF ENVIRONMENTAL QUALITY OPDES CONSTRUCTION GENERAL PERMIT OKR10.
- A COPY OF THE EROSION CONTROL SITE PLAN MUST BE ON SITE AND MADE AVAILABLE TO THE INSPECTOR UPON REQUEST.
- THE CONTRACTOR SHALL BE RESPONSIBLE FOR THE MAINTENANCE, REPAIR OR REPLACEMENT OF ALL EROSION CONTROL DEVICES.
- UPON COMPLETION OF LAND DISTURBING ACTIVITIES, PERMITTEE MUST STABILIZE THE ENTIRE SITE BY PLANTING, GROWING AND ESTABLISHING A UNIFORM PERENNIAL VEGETATIVE COVER UNTIL A DENSITY OF AT LEAST 70 PERCENT OF THE NATIVE BACKGROUND COVER HAS BEEN ESTABLISHED FOR ALL UNPAVED AREAS.
- THE CONTRACTOR MAY BE REQUIRED TO INSTALL ADDITIONAL EROSION CONTROL DEVICES BEFORE WATERLINE FLUSHING ACTIVITIES TO MINIMIZE EROSION AND TO REMAIN IN COMPLIANCE WITH LOCAL & FEDERAL NPDES PERMIT REQUIREMENTS. WATER LINE FLUSHING TO THE STORM DRAINAGE SYSTEM OR TO WATERS OF THE COMMUNITY IS ALLOWABLE PROVIDED THAT THERE IS NO MEASURABLE AMOUNT OF RESIDUAL CHLORINE (DEFINED AS < 0.1 MG/L).

EROSION CONTROL QUANTITIES (BY DEVELOPER)

1.	SILT FENCE	L.F.	205	
2.	TEMP. CONSTRUCTION ENTRANCE	EA	1	
3.	CONC. WASHOUT	EA	1	

SWQ PERMIT: SWL-2025-00651

BILLING ADDRESS

12613 S. WESTERN AVE
OKLAHOMA CITY, OK 73170

BLDC-TBD

BELOW FOR CITY USE ONLY

- DEQ REQUIRED REC'VD
 EASEMENT REQUIRED REC'VD
 FH FLOW TEST REQUIRED REC'VD

BUILDING ADDRESS

12613 S. WESTERN AVE
OKLAHOMA CITY, OK 73170

REFERENCED WATER STANDARD DETAILS

INDEX 500-10/16/2023

EROSION CONTROL NOTES

- A. SEDIMENT BASINS ARE ATTRACTIVE TO CHILDREN AND CAN BE VERY DANGEROUS. IN ALL CASES, LOCAL ORDINANCES AND REGULATIONS REGARDING HEALTH AND SAFETY MUST BE ADHERED TO.
- B. ALL CONTRACTORS AND SUBCONTRACTORS INVOLVED WITH STORM WATER POLLUTION PREVENTION PLAN AND THE STATE OF OKLAHOMA NATIONAL POLLUTANT DISCHARGE ELIMINATION SYSTEM GENERAL PERMIT (NPDES PERMIT) AND BECOME FAMILIAR WITH THEIR CONTENTS.
- C. ALL TEMPORARY EROSION AND SEDIMENT CONTROL MEASURES SHALL BE DISPOSED OF WITHIN 30 DAYS AFTER FINAL STABILIZATION. FINAL STABILIZATION HAS OCCURRED WHEN ALL SOIL DISTURBING ACTIVITIES ARE COMPLETED AND A UNIFORM PERENNIAL VEGETATIVE COVER WITH A DENSITY OF 70% OF THE COVER FOR UNPAVED AREAS AND AREAS NOT COVERED BY PERMANENT STRUCTURES HAS BEEN EMPLOYED.
- D. BEST MANAGEMENT PRACTICES (BMP'S) AND CONTROLS SHALL CONFORM TO FEDERAL, STATE, OR LOCAL REQUIREMENTS OR MANUAL OF PRACTICE, AS APPLICABLE. CONTRACTOR SHALL IMPLEMENT ADDITIONAL CONTROLS AS DIRECTED BY PERMITTING AGENCY OR OWNER.
- E. CONTRACTOR SHALL MINIMIZE CLEARING TO THE MAXIMUM EXTENT PRACTICAL OR AS REQUIRED BY THE GENERAL PERMIT.
- F. GENERAL CONTRACTOR SHALL DENOTE ON PLAN THE TEMPORARY PARKING AND STORAGE AREA WHICH SHALL ALSO BE USED AS THE EQUIPMENT MAINTENANCE AND CLEANING AREA, EMPLOYEE PARKING AREA, AND AREA FOR LOCATING PORTABLE FACILITIES, OFFICE TRAILERS, AND TOILET FACILITIES.
- G. ALL WASH WATER (CONCRETE TRUCKS, VEHICLE CLEANING, EQUIPMENT CLEANING, ETC.) SHALL BE DETAINED AND PROPERLY TREATED OR DISPOSED.
- H. SUFFICIENT OIL AND GREASE ABSORBING MATERIALS AND FLOTATION BOOMS SHALL BE MAINTAINED ON SITE OR READILY AVAILABLE TO CONTAIN AND CLEAN-UP FUEL OR CHEMICAL SPILLS AND LEAKS.
- I. DUST ON THE SITE SHALL BE CONTROLLED. THE USE OF MOTOR OILS AND OTHER PETROLEUM BASED OR TOXIC LIQUIDS FOR DUST SUPPRESSION OPERATIONS IS PROHIBITED.
- J. RUBBISH, TRASH, GARBAGE, LITTER, OR OTHER SUCH MATERIALS SHALL BE DEPOSITED INTO SEALED CONTAINERS. MATERIALS SHALL BE PREVENTED FROM LEAVING THE PREMISES THROUGH THE ACTION OF WIND OR STORMWATER DISCHARGE INTO DRAINAGE DITCHES OR WATERS OF THE STATE.
- K. ALL STORM WATER POLLUTION PREVENTION MEASURES PRESENTED ON THIS PLAN, AND IN THE STORM WATER POLLUTION PREVENTION PLAN, SHALL BE INITIATED AS SOON AS PRACTICABLE.
- L. DISTURBED PORTIONS OF THE SITE WHERE CONSTRUCTION ACTIVITY HAS STOPPED FOR AT LEAST 14 DAYS, SHALL BE TEMPORARILY SEEDED. THESE AREAS SHALL BE SEEDED NO LATER THAN 14 DAYS FROM THE LAST CONSTRUCTION ACTIVITY OCCURRING IN THESE AREAS.
- M. DISTURBED PORTIONS OF THE SITE WHERE CONSTRUCTION ACTIVITY HAS PERMANENTLY STOPPED SHALL BE PERMANENTLY SEEDED. THESE AREAS SHALL BE SEEDED NO LATER THAN 14 DAYS AFTER THE LAST CONSTRUCTION ACTIVITY OCCURRING IN THESE AREAS. REFER TO THE GRADING PLAN AND/OR LANDSCAPE PLAN.
- N. IF THE ACTION OF VEHICLES TRAVELING OVER THE GRAVEL CONSTRUCTION ENTRANCES IS NOT SUFFICIENT TO REMOVE THE MAJORITY OF DIRT OR MUD, THEN THE TIRES MUST BE WASHED BEFORE THE VEHICLES ENTER A PUBLIC ROAD. IF WASHING IS USED, PROVISIONS MUST BE MADE TO INTERCEPT THE WASH WATER AND TRAP THE SEDIMENT BEFORE IT IS CARRIED OFF THE SITE.
- O. ALL MATERIALS SPILLED, DROPPED, WASHED, OR TRACKED FROM VEHICLES ONTO ROADWAYS OR INTO STORM DRAINS MUST BE REMOVED IMMEDIATELY.
- P. CONTRACTORS OR SUBCONTRACTORS WILL BE RESPONSIBLE FOR REMOVING SEDIMENT IN THE DETENTION POND AND ANY SEDIMENT THAT MAY HAVE COLLECTED IN THE STORM SEWER DRAINAGE SYSTEMS IN CONJUNCTION WITH THE STABILIZATION OF THE SITE.
- Q. ON-SITE & OFFSITE SOIL STOCKPILE AND BORROW AREAS SHALL BE PROTECTED FROM EROSION AND SEDIMENTATION THROUGH IMPLEMENTATION OF BEST MANAGEMENT PRACTICES. STOCKPILE AND BORROW AREA LOCATIONS SHALL BE NOTED ON THE SITE PLAN AND PERMITTED IN ACCORDANCE WITH GENERAL PERMIT REQUIREMENTS.
- R. SLOPES SHALL BE LEFT IN A ROUGHENED CONDITION DURING THE GRADING PHASE TO REDUCE RUNOFF VELOCITIES AND EROSION.
- S. DUE TO THE GRADE CHANGES DURING THE DEVELOPMENT OF THE PROJECT, THE CONTRACTOR SHALL BE RESPONSIBLE FOR ADJUSTING THE EROSION CONTROL MEASURES (SILT FENCES, STRAW BALES, ETC.) TO PREVENT EROSION.
- T. ALL CONSTRUCTION SHALL BE STABILIZED AT THE END OF EACH WORKING DAY. THIS INCLUDES BACKFILLING OF TRENCHES FOR UTILITY CONSTRUCTION AND PLACEMENT OF GRAVEL OR BITUMINOUS PAVING FOR ROAD CONSTRUCTION.
- U. A 3' STRIP OF SOD SHALL BE PLACED ALONG THE EDGE OF ALL PAVING TO ACT AS A SEDIMENT BUFFER AND AID IN THE ESTABLISHMENT OF VEGETATION.

LOCATION MAP:

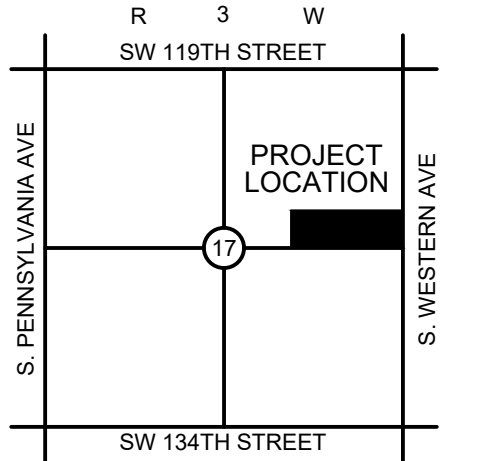

NOT TO SCALE

PROJECT:

WESTMOORE HIGH SCHOOL ENTRY ADDITION
 OKLAHOMA CITY, OK

PROJECT NUMBER: 25042
 DRAWING DATE: 09.19.25
 ISSUE DATE: 09.19.25

SEAL:



SUBMITAL:

CONSTRUCTION DRAWINGS

REVISIONS:

MARK	DATE	DESCRIPTION

THESE PLANS AND DRAWINGS ARE NOT TO BE REPRODUCED, CHANGED OR COPIED IN ANY FORM OR MANNER WHATSOEVER WITHOUT FIRST OBTAINING THE WRITTEN PERMISSION AND CONSENT OF CEDAR CREEK CONSULTING INC. THIS SHEET IS NOT TO BE USED FOR CONSTRUCTION UNLESS THE ISSUE DATE IN THE TITLE BLOCK COINCIDES WITH OR POST DATES THE DRAWING DATE. ANY CHANGES MADE FROM THESE PLANS WITHOUT CONSENT OF CEDAR CREEK CONSULTING INC. ARE UNAUTHORIZED AND SHALL RELIEVE CEDAR CREEK CONSULTING OF RESPONSIBILITY FOR ALL CONSEQUENCES ARISING OUT OF SUCH CHANGES.

DRAWING TITLE:

EROSION CONTROL PLAN

SHEET:

C3.00

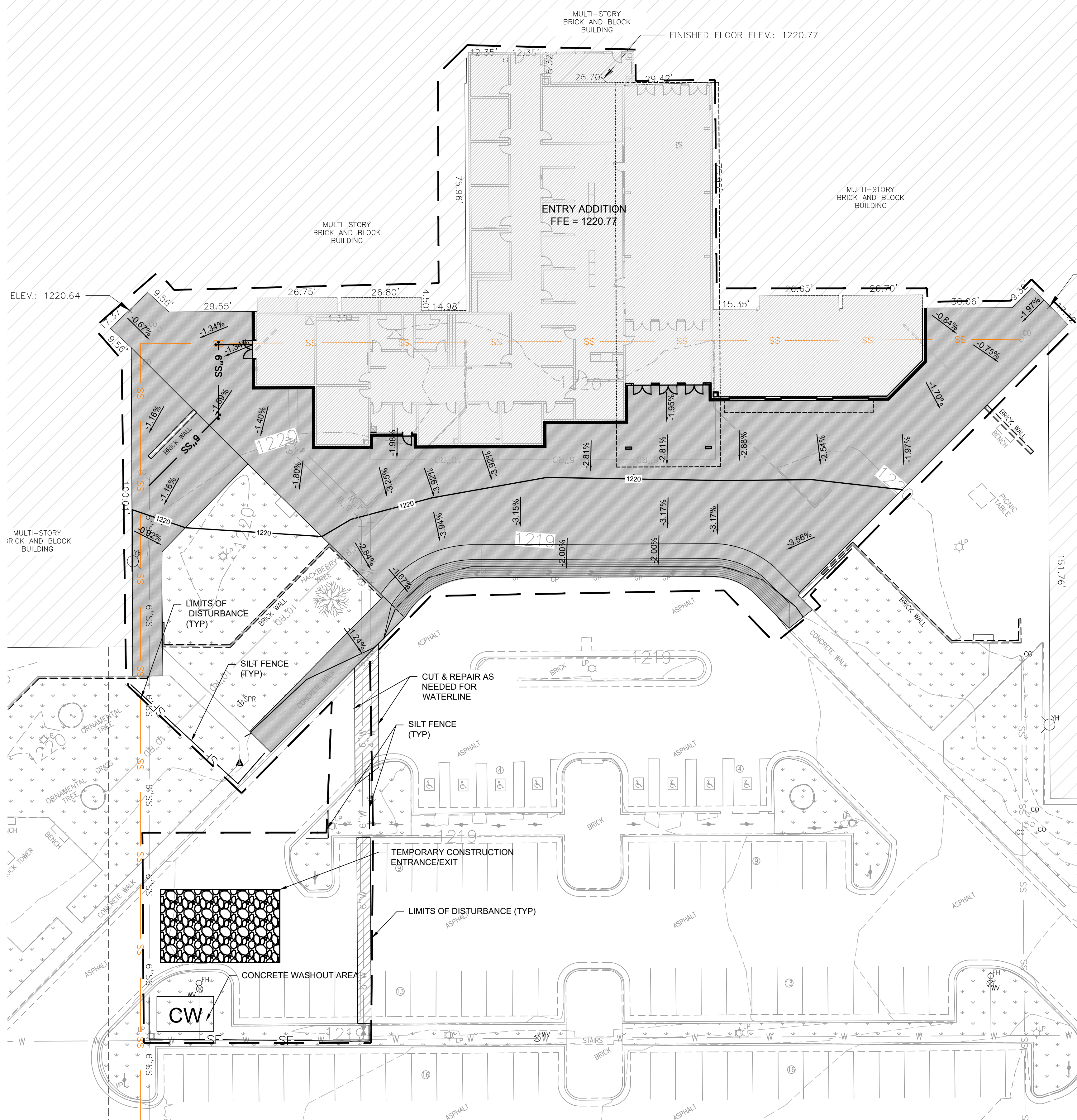

LEGEND

- EXISTING 1' CONTOUR
- EXISTING 5' CONTOUR
- PROPOSED 1' CONTOUR
- PROPOSED 5' CONTOUR
- BOUNDARY LINE
- RIGHT OF WAY LINE
- EASEMENT LINE
- EXISTING CURB AND GUTTER
- PROPOSED CURB AND GUTTER
- PROPOSED FIRE LANE STRIPING
- OHE OVERHEAD ELECTRIC LINE
- UGE UNDERGROUND ELECTRIC LINE
- GAS GAS LINE
- UGT UNDERGROUND TELEPHONE LINE
- FO UNDERGROUND FIBER OPTIC LINE
- SS SANITARY SEWER LINE
- W WATERLINE
- RETAINING WALL
- SCREEN WALL
- WIRE FENCE
- CHAIN LINK FENCE
- BENCHMARK
- ▲ PROP. FIRE HYDRANT
- ▼ PROP. WATER VALVE
- PROP. WATER METER
- PROP. ELECT. METER
- ⊙ PROP. LIGHT POLE
- PROP. BOLLARD
- ⊠ PROP. TRANSFORMER
- ⊙ PROP. PARKING COUNT
- PROP. WHEEL STOP
- ▭ PROP. FES
- ▭ PROP. HC RAMP
- ▭ PROP. POWER POLE
- ⊙ PROP. SS MANHOLE
- ▲ PROP. GAS METER
- ▼ PROP. SIGN
- ⊙ PROP. FIRE ROUTE SIGN
- LIMITS OF DISTURBANCE
- SF SILT FENCE
- TD--> TEMPORARY DIVERSION DIKE
- SODDING
- ⊙ INLET PROTECTION
- ⊠ CONCRETE WASHOUT AREA

*NOTE: REFER TO SURVEYING LEGEND FOR EXISTING STRUCTURES IDENTIFICATION

SEQUENCE OF CONSTRUCTION

- PHASE 1**
1. A PRE-CONSTRUCTION MEETING SHALL BE HELD BY THE GENERAL CONTRACTOR'S MANAGER, AND THE OPERATOR'S ENGINEER PRIOR TO LAND DISTURBING ACTIVITIES.
 2. PREPARE AND PULL ALL NECESSARY PERMITS.
 3. CONSTRUCT TEMPORARY CONSTRUCTION EXITS AT LOCATIONS SHOWN ON THE SWPPP PLANS AND PREPARE TEMPORARY PARKING AND STORAGE AREA, UPON IMPLEMENTATION AND INSTALLATION OF THE FOLLOWING AREAS: TRAILER, PARKING, LAY DOWN, PORTA-POTTY, WELL WASH, CONCRETE WASHOUT, MASONS AREA, FUEL AND MATERIAL STORAGE CONTAINERS, SOLID WASTE CONTAINERS, ETC. DENOTE THEM ON THE SITE MAPS IMMEDIATELY AND NOTE ANY CHANGE IN THE LOCATIONS AS THEY OCCUR THROUGHOUT THE CONSTRUCTION PROCESS.
 4. CONSTRUCT THE SILT FENCES ON THE SITE. HALT ALL ACTIVITIES AND CONTACT THE CIVIL ENGINEERING CONSULTANT TO PERFORM INSPECTION AND CERTIFICATION OF BMP'S. GENERAL CONTRACTOR SHALL SCHEDULE AND CONDUCT STORMWATER PRE-CONSTRUCTION MEETING WITH ENGINEER AND ALL GROUND-DISTURBING CONTRACTORS BEFORE PROCEEDING WITH CONSTRUCTION.
 5. INSTALL PUBLIC WATER, SEWER AND BOX CULVERT
 6. DEMO, CLEAR AND GRUB THE SITE.
 7. BEGIN GRADING THE SITE.
 8. START CONSTRUCTION OF BUILDING PAD AND STRUCTURES.
 9. DISTURBED AREAS OF THE SITE WHERE CONSTRUCTION ACTIVITY HAS CEASED FOR MORE THAN 14 DAYS SHALL BE TEMPORARILY SEEDED AND WATERED.
- PHASE 2**
1. INSTALL UTILITIES, UNDER DRAINS, STORM SEWERS, CURB AND GUTTERS.
 2. INSTALL INLET PROTECTION DEVICES.
 3. INSTALL RIP RAP AROUND OUTLET STRUCTURES.
 4. FINALIZE PAVEMENT SUBGRADE PREPARATION.
 5. INSTALL BASE MATERIAL AS REQUIRED FOR PAVEMENT.
 6. PAVE LOT.
 7. REMOVE TEMPORARY CONSTRUCTION EXITS ONLY PRIOR TO PAVEMENT CONSTRUCTION IN THESE AREAS. (THESE AREAS TO BE PAVED LAST)
 8. DISTURBED AREAS OF THE SITE WHERE CONSTRUCTION ACTIVITY HAS CEASED FOR MORE THAN 14 DAYS SHALL BE TEMPORARILY SEEDED AND WATERED.
 9. FINE GRADE AND INSTALL PERMANENT SEEDING AND PLANTINGS.
 10. REMOVE ALL TEMPORARY EROSION AND SEDIMENT CONTROLS DEVICED. (ONLY IF SITE IS STABILIZED)
 11. REMOVE INLET PROTECTIONS AROUND INLETS AND MANHOLES NO MORE THAN 48 HOURS PRIOR TO PLACING STABILIZED BASE COURSE.

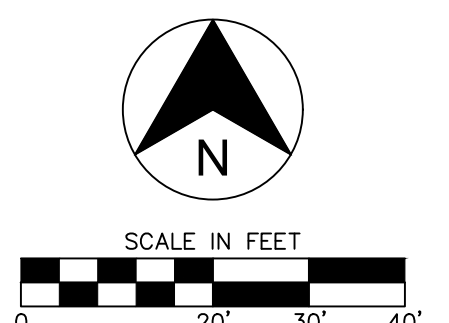

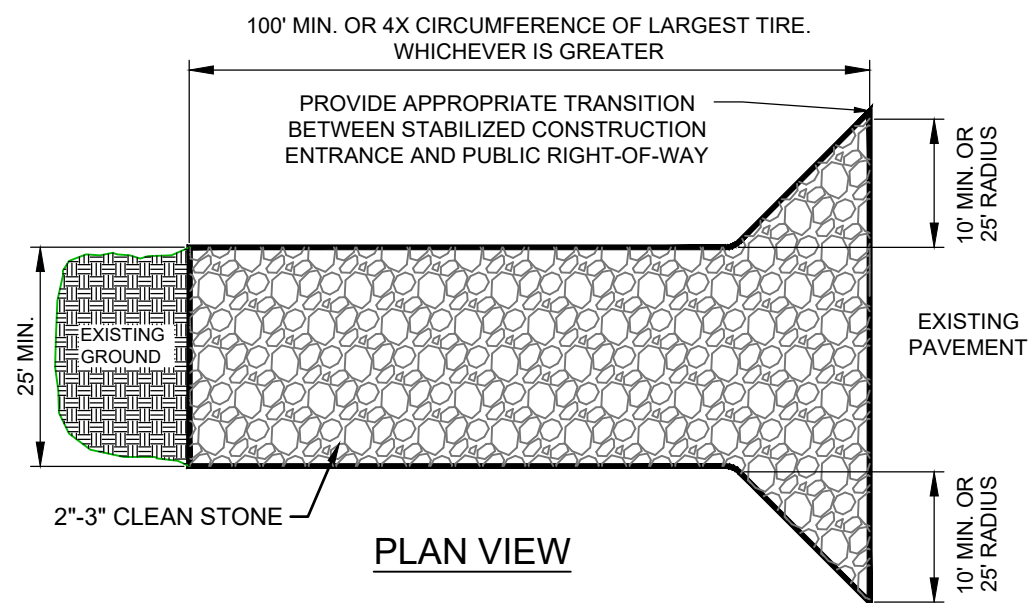
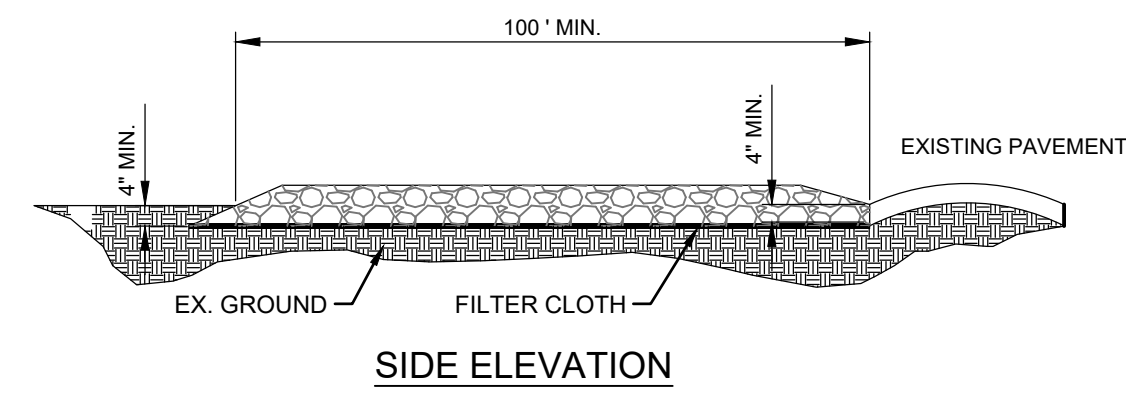

- NOTES:
- STONE - USE COARSE AGGREGATE (2 - 3 INCH STONE)
 - LENGTH - AS EFFECTIVE, BUT NOT LESS THAN 100 FEET.
 - THICKNESS - NOT LESS THAN EIGHT (8) INCHES.
 - WIDTH - NOT LESS THAN FULL WIDTH OF ALL POINTS OF INGRESS OR EGRESS.
 - WASHING - WHEN NECESSARY, WHEELS SHALL BE CLEANED TO REMOVE SEDIMENT PRIOR TO ENTRANCE ONTO PUBLIC RIGHT-OF-WAY. WHEN WASHING IS REQUIRED, IT SHALL BE DONE ON AN AREA STABILIZED WITH CRUSHED STONE WHICH DRAINS INTO AN APPROVED SEDIMENT TRAP OR SEDIMENT BASIN. ALL SEDIMENT SHALL BE PREVENTED FROM ENTERING ANY STORM DRAIN, DITCH, OR WATERCOURSE THROUGH USE OF SAND BAGS, GRAVEL, BOARDS OR OTHER APPROVED METHODS.
 - MAINTENANCE - THE ENTRANCE SHALL BE MAINTAINED IN A CONDITION WHICH WILL PREVENT TRACKING OR FLOWING OF SEDIMENT ONTO PUBLIC RIGHT-OF-WAY. THIS MAY REQUIRE PERIODIC TOP DRESSING WITH ADDITIONAL STONE AS CONDITIONS DEMAND AND REPAIR AND/OR CLEANOUT OF ANY MEASURES USED TO TRAP SEDIMENT. ALL SEDIMENT SPILLED, DROPPED, WASHED OR TRACKED ONTO PUBLIC RIGHTS-OF-WAY MUST BE REMOVED IMMEDIATELY.
 - 12' X 24' METAL GRATE MAY BE USED. GRATE SHALL BE 25' AWAY FROM PAVEMENT AND APPROPRIATE SEDIMENT CONTROL TRAPPING DEVICE SHALL BE USED AT GRATE OUTLET POINT.

STABILIZED CONSTRUCTION ENTRANCE
 NOT TO SCALE

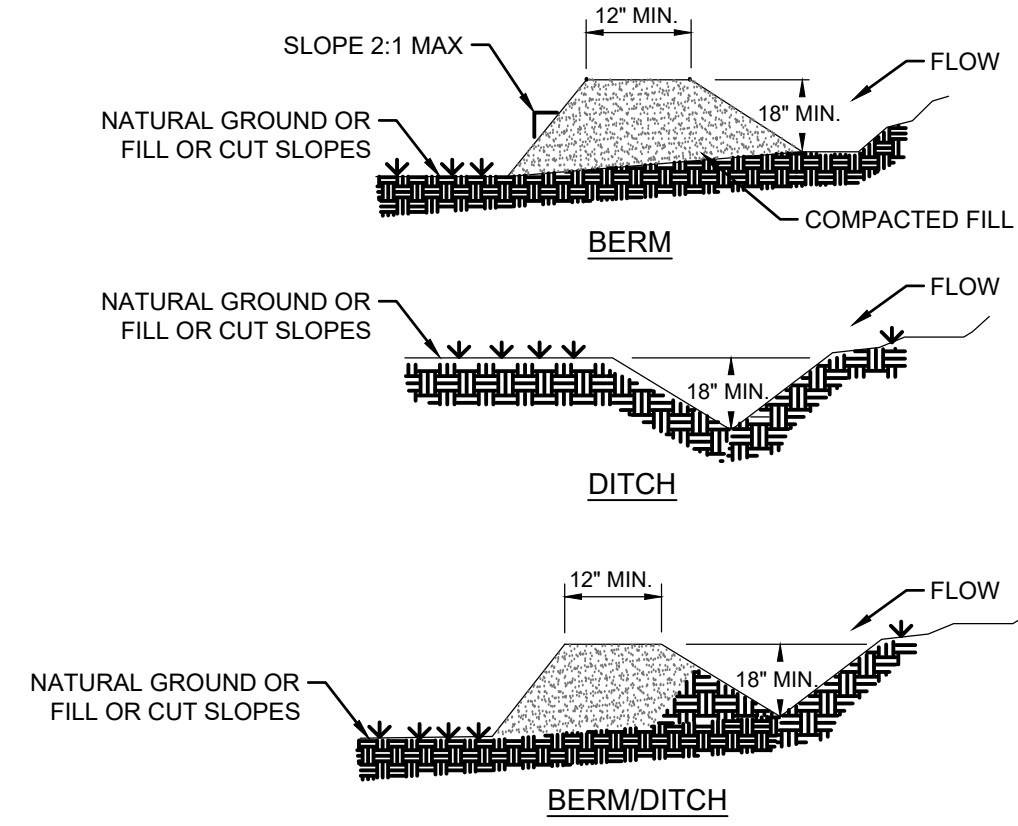

- NOTES:
- POSITIVE GRADE MUST BE PROVIDED TO ASSURE DRAINAGE. IF SLOPE EXCEEDS 2%, SEED AND MULCH DIVERSION, TRY NOT TO EXCEED 5% (HIGH RUNOFF VELOCITIES RESULT). MAXIMUM DRAINAGE AREA IS 5.00 ACRES WITHOUT SUPPORTING CALCULATIONS FOR PERMANENT CHANNEL. DIVERSIONS AT THE TOPS OF SLOPES MUST EMPTY INTO AN APPROVED SLOPE DRAIN (SEE DETAILS). THE BERM/ DITCH IS THE MOST COMMONLY USED DIVERSION.
 - MACHINE COMPACTION OF ALL FILL IS REQUIRED.
 - DIVERSIONS SUFFICIENT TO DIRECT ALL SEDIMENT-LADEN STORMWATER INTO SEDIMENT CONTROL DEVICE MUST BE INSTALLED PRIOR TO CLEARING AND GRUBBING OF AREA (OR IN CONJUNCTION WITH THIS OPERATION IF SEDIMENT CONTROLS AND DIVERSIONS ARE INSTALLED AT EACH CRITICAL POINT AS INDICATED).
 - DIVERSIONS SHOULD BE LOCATED TO MINIMIZE DAMAGES BY CONSTRUCTION OPERATIONS.
 - DIVERSIONS SHOULD BE SEEDED AND MULCHED IF THEY ARE TO REMAIN IN PLACE OVER 14 DAYS.
 - CHECK DIVERSIONS AFTER EACH RAIN, OR ONCE PER WEEK WHICH EVER IS THE SHORTER DURATION. REPAIR AS NEEDED TO MAINTAIN FUNCTION.

TEMPORARY DIVERSION BERM/DITCH DETAIL
 NOT TO SCALE

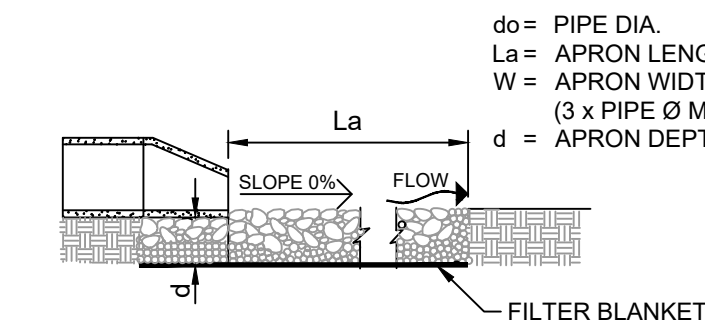
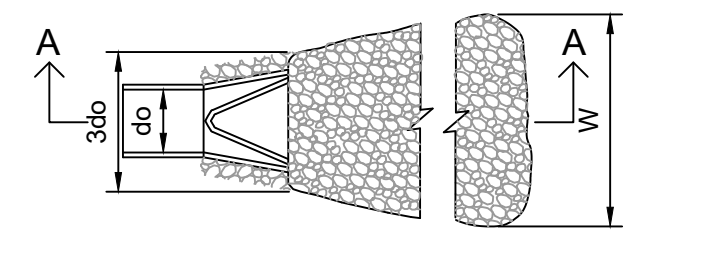
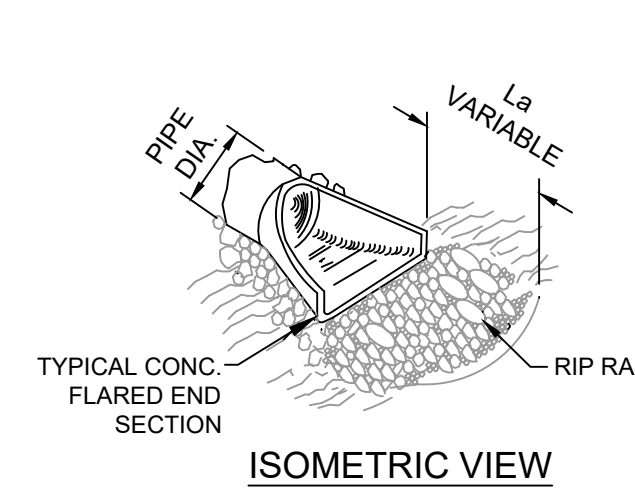

- NOTES:
- SEE APPROPRIATE PLAN OR SCHEDULE FOR DIMENSIONS
- La IS THE LENGTH OF THE RIP RAP APRON.
 - d = 1.5 TIMES THE MAXIMUM STONE DIAMETER BUT NOT LESS THAN 6".
 - A FILTER BLANKET OR FILTER FABRIC SHOULD BE INSTALLED BETWEEN THE RIP-RAP AND SOIL FOUNDATION.

RIP RAP APRON DETAIL
 NOT TO SCALE

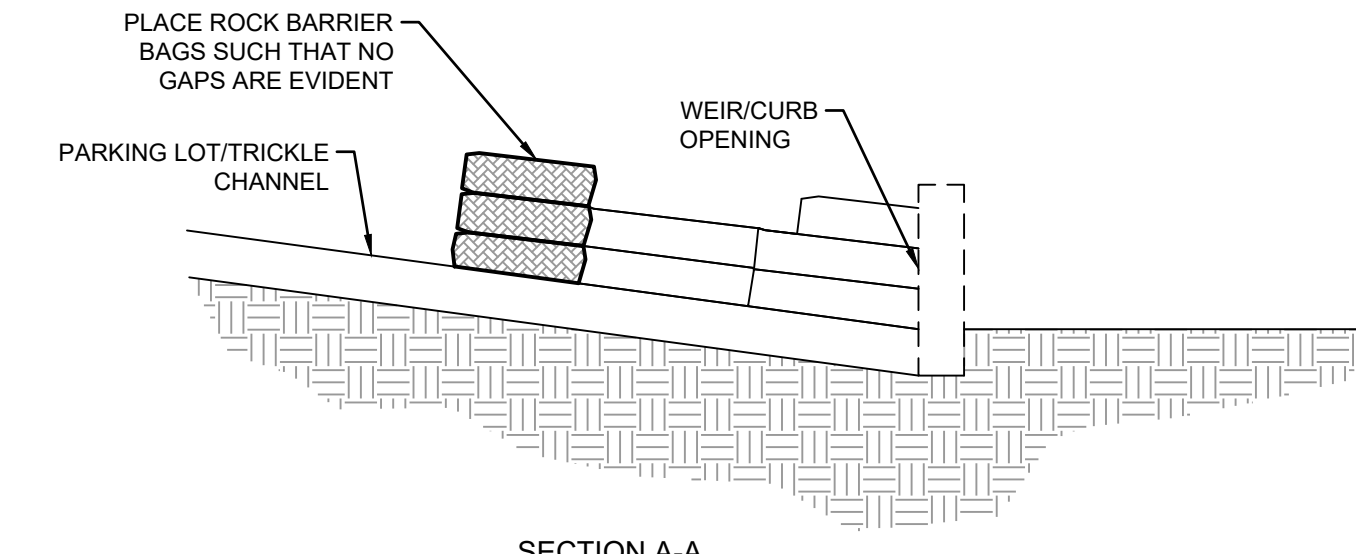
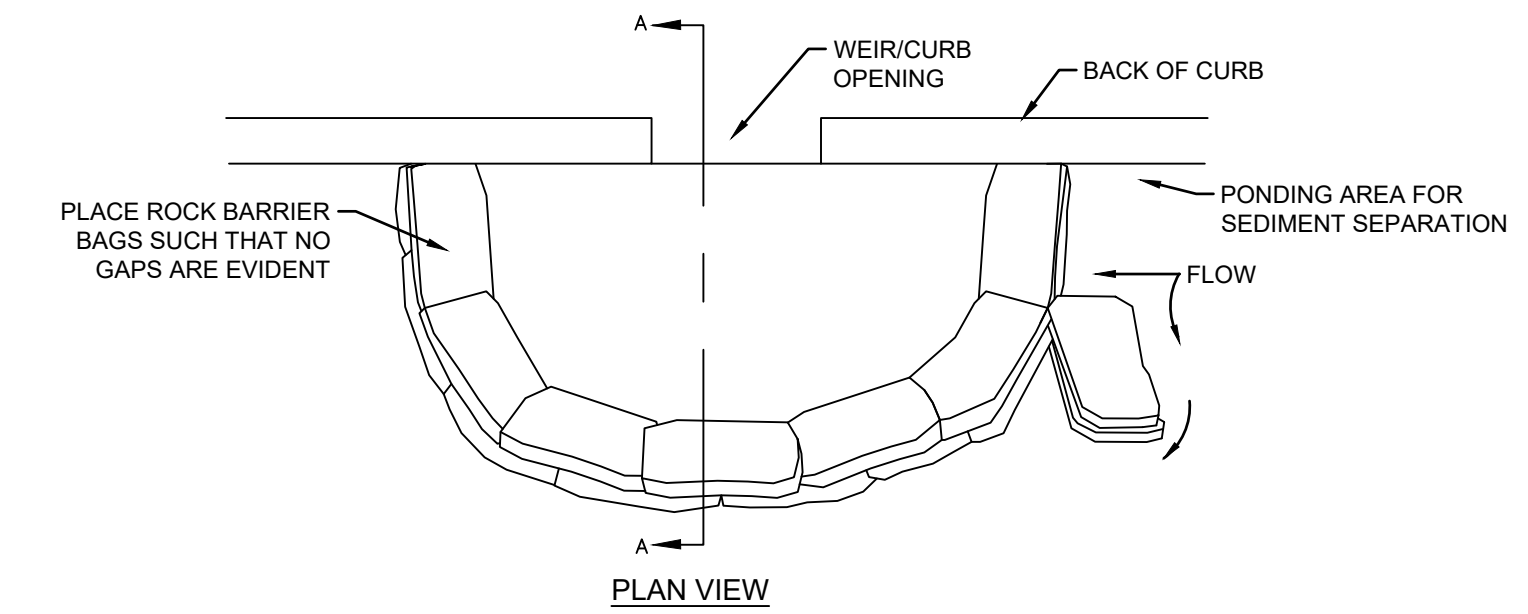

- NOTES:
- PLACE CURB TYPE ROCK BAG BARRIER ON GENTLY SLOPING PAVING, WHERE WATER CAN POND AND ALLOW SEDIMENT TO SEPARATE FROM RUNOFF.
 - BAGS OF WOVEN GEOTEXTILE FABRIC, FILLED WITH GRAVEL MUST BE LAYERED SUCH THAT NO GAPS ARE EVIDENT.
 - LEAVE ON ROCKBAG GAP IN THE TOP ROW ON THE SIDE AWAY FROM FLOW, TO PROVIDE A SPILLWAY, OR IN THE CENTER IF PONDING IS NEEDED ON BOTH SIDES.
 - INSPECT BARRIERS AND REMOVE SEDIMENT AFTER EACH STORM EVENT, SEDIMENT AND GRAVEL MUST BE REMOVED FROM THE TRAVELED WAY IMMEDIATELY.

CURB INLET PROTECTION DETAIL
 NOT TO SCALE

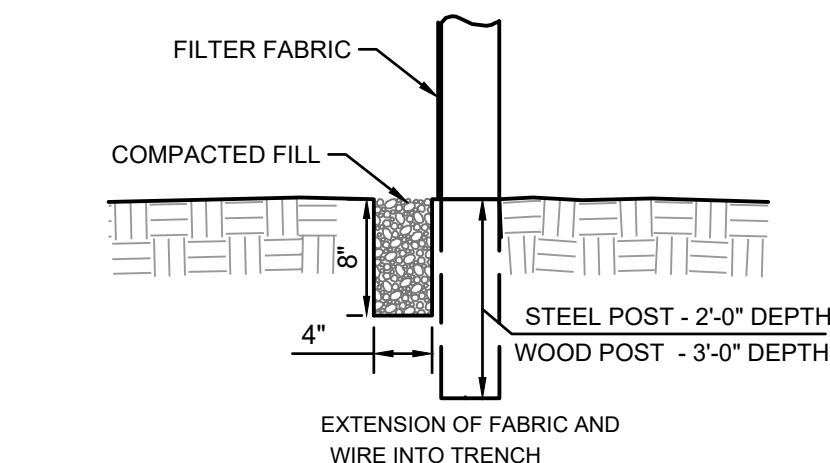
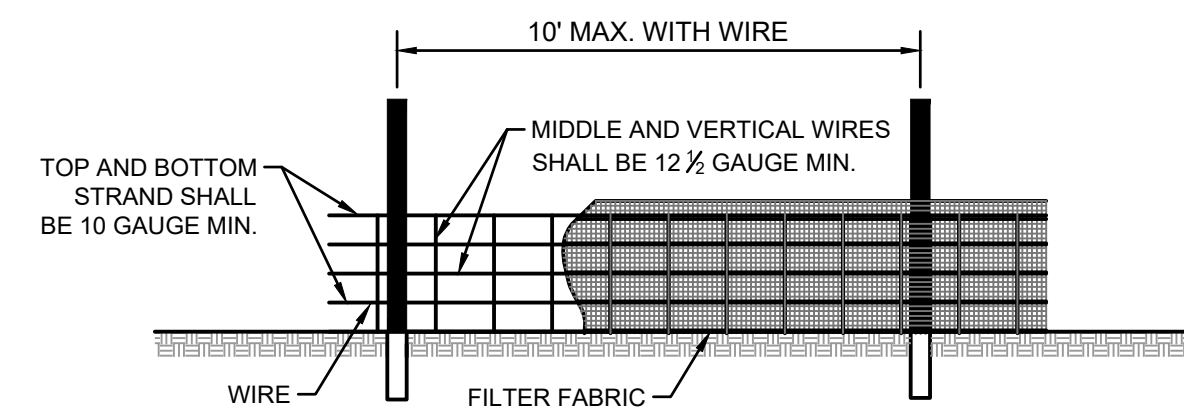

- NOTES:
- WIRE SHALL BE A MINIMUM OF 32" IN WIDTH AND SHALL HAVE A MINIMUM OF 6 LINE WIRES WITH 12" STAY SPACING.
 - FILTER FABRIC SHALL BE A MINIMUM OF 36" IN WIDTH AND SHALL BE FASTENED ADEQUATELY TO THE WIRE.
 - STEEL POST SHALL BE 5'-0" IN HEIGHT AND BE OF THE SELF-FASTENER ANGLE STEEL TYPE.
 - WOOD POST SHALL BE 6'-0" IN HEIGHT AND 3" IN DIAMETER.

SILT FENCE DETAIL
 NOT TO SCALE

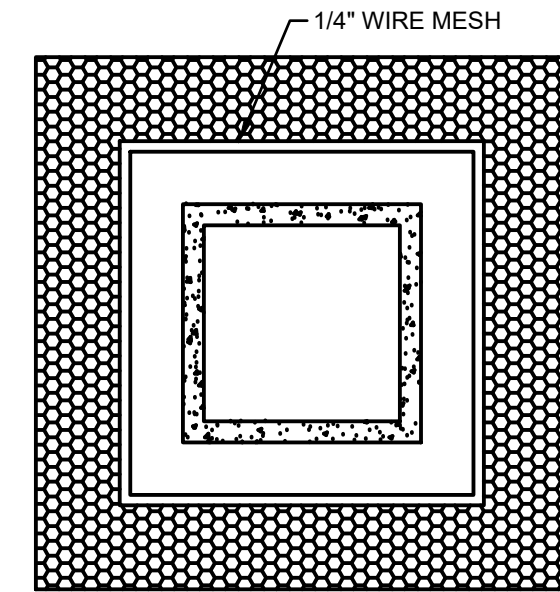
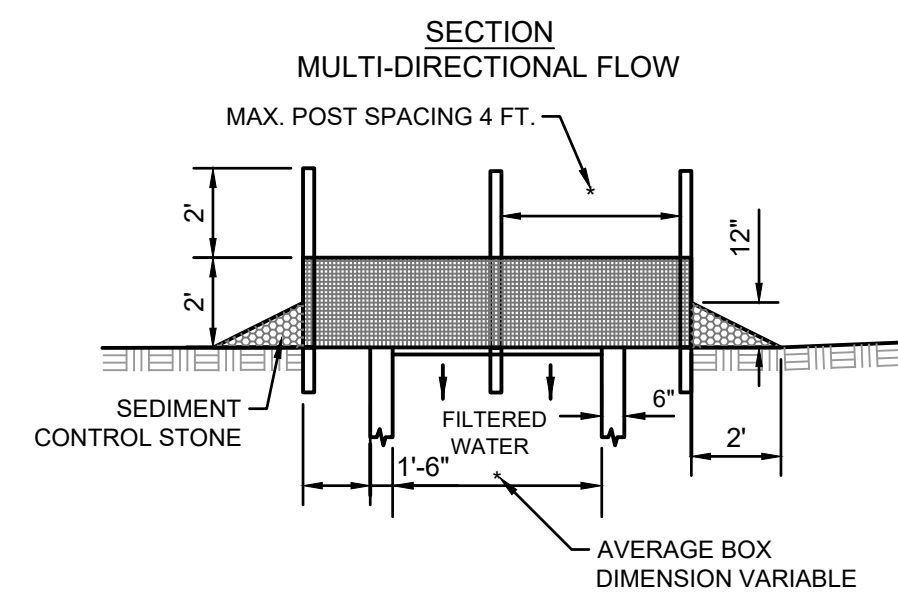

- NOTES:
- SEDIMENT CONTROL STONE SHALL BE 3/4" WASHED STONE.
 - WIRE MESH SHALL BE HARDWARE CLOTH 23 GAUGE MIN. AND SHALL HAVE 1/4 INCH MESH OPENINGS.
 - TOP OF WIRE MESH SHALL BE A MINIMUM OF ONE FOOT BELOW THE SHOULDER OR ANY DIVERSION POINT.
 - STEEL POST SHALL BE 5 FT. IN HEIGHT, BE INSTALLED 1.5 FT. DEEP MINIMUM, AND BE OF THE SELF-FASTENER ANGLE STEEL TYPE.
 - WOOD POST SHALL BE 6 FT. IN HEIGHT, BE INSTALLED TO 1.5 FT. DEEP MINIMUM, AND BE 3 INCHES IN DIAMETER.
 - POST SPACING SHALL BE A MAXIMUM OF 4 FT.

INLET PROTECTION DETAIL
 NOT TO SCALE

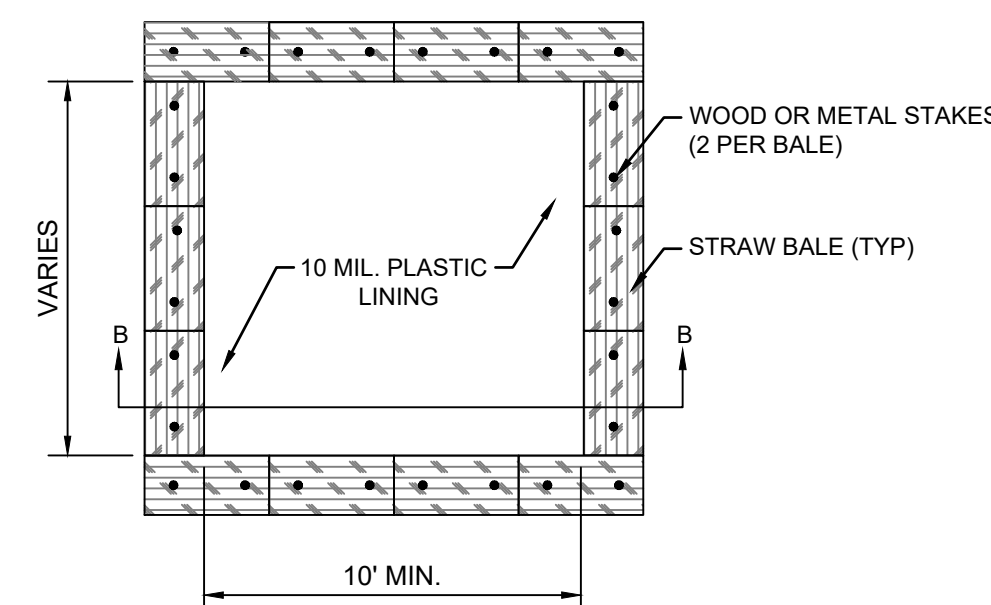
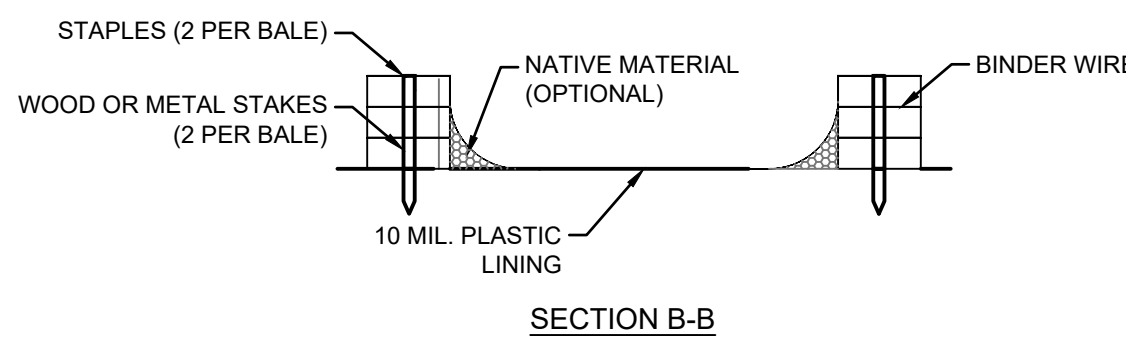

TYPE 'ABOVE GRADE' WITH STRAW BALES

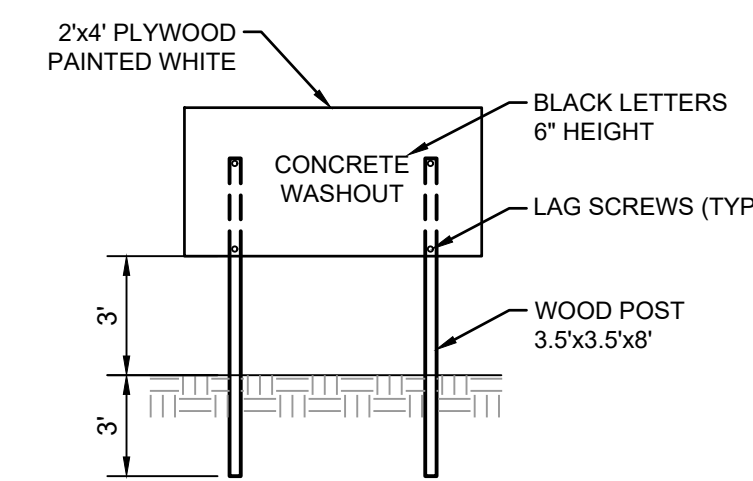

CONCRETE WASHOUT SIGN DETAIL

- NOTES:
- ACTUAL LAYOUT TO BE DETERMINED IN THE FIELD.
 - A CONCRETE WASHOUT SIGN SHALL BE INSTALLED WITHIN 30' OF THE TEMPORARY CONCRETE WASHOUT FACILITY
 - MATERIALS USED TO CONSTRUCT TEMPORARY CONCRETE WASHOUT FACILITIES SHALL BE REMOVED FROM THE SITE OF THE WORK AND DISPOSED OF OR RECYCLED.
 - HOLES, DEPRESSIONS OR OTHER GROUND DISTURBANCE CAUSED BY THE REMOVAL OF THE TEMPORARY CONCRETE WASHOUT FACILITIES SHALL BE BACKFILLED, REPAIRED AND STABILIZED TO PREVENT EROSION.

CONCRETE WASHOUT DETAIL
 NOT TO SCALE

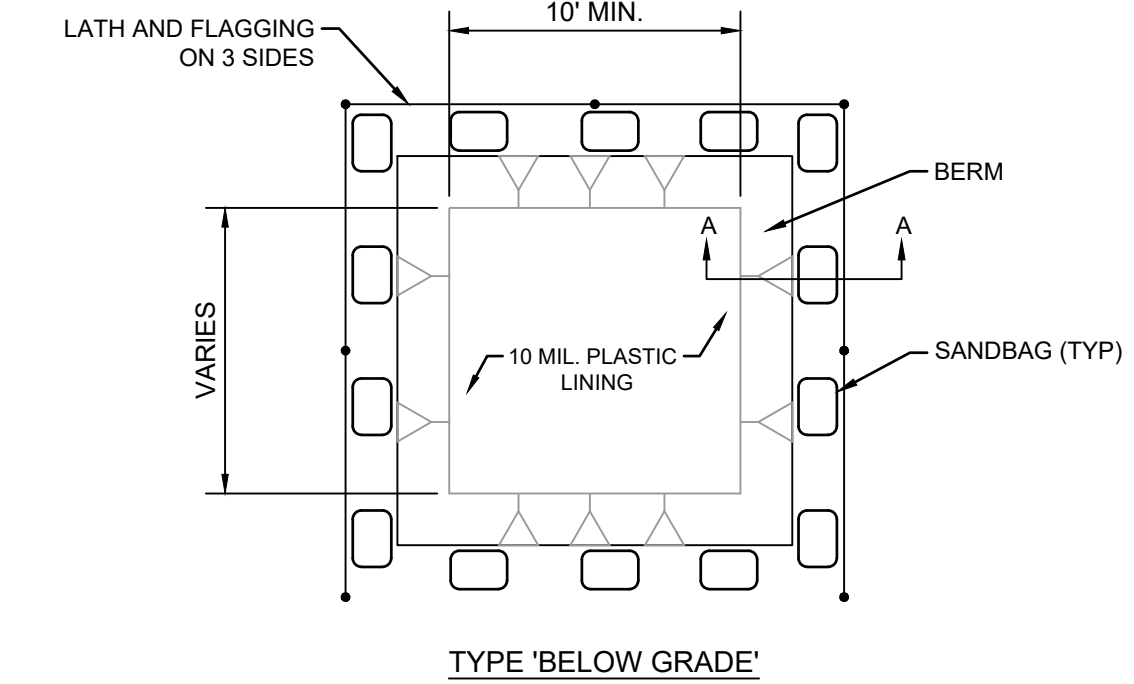
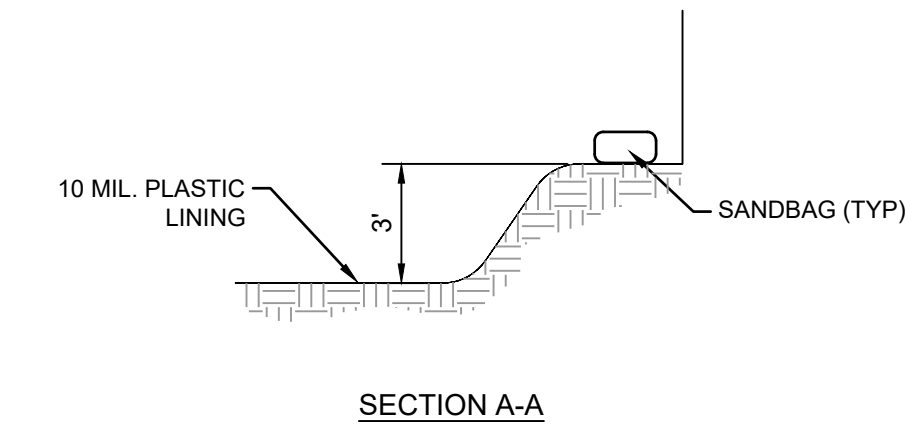

TYPE 'BELOW GRADE'

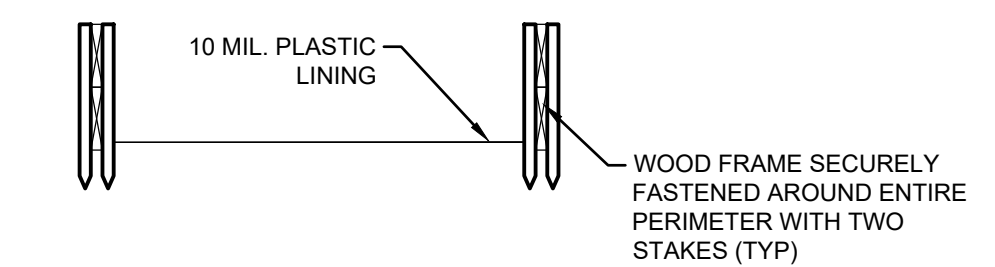

SECTION C-C

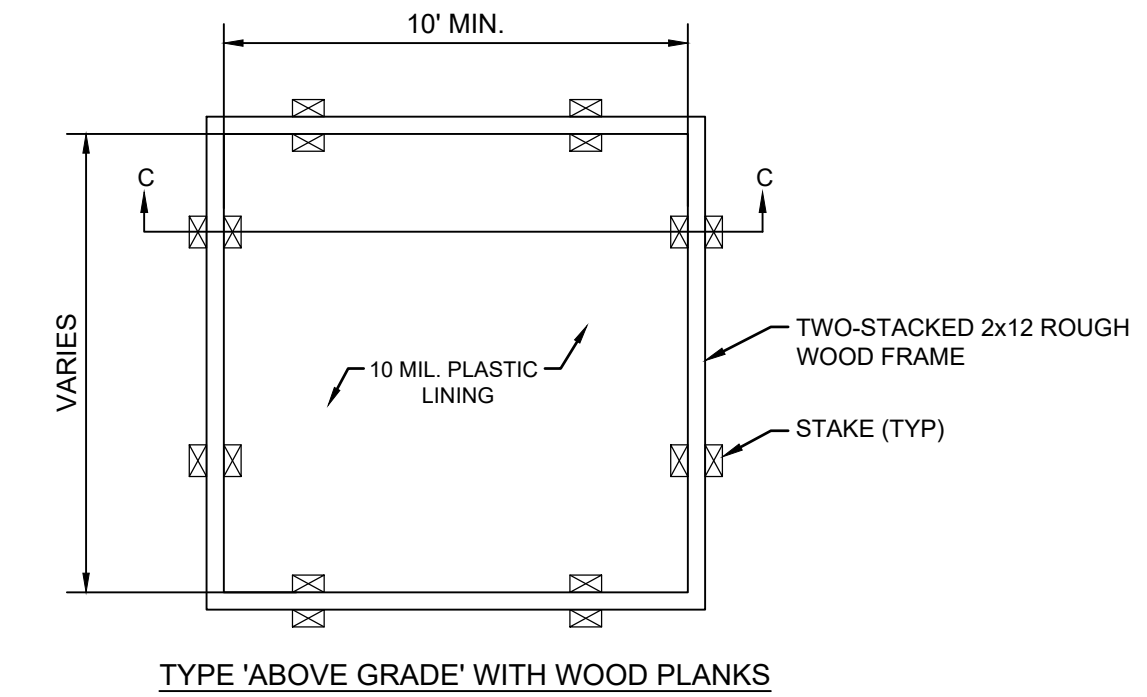

TYPE 'ABOVE GRADE' WITH WOOD PLANKS

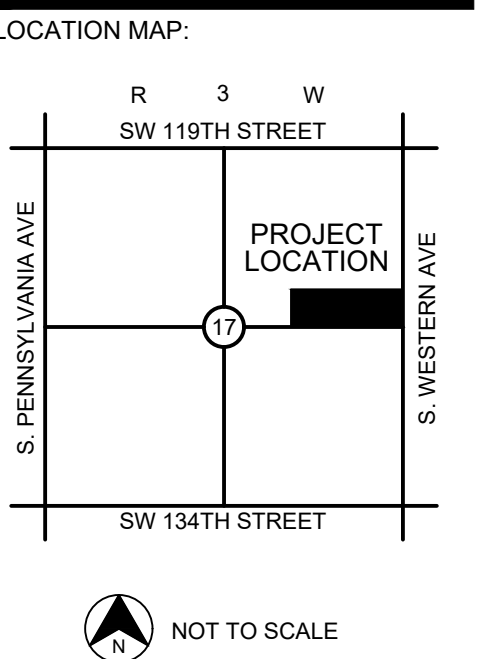

PROJECT:
WESTMOORE HIGH SCHOOL ENTRY ADDITION
 OKLAHOMA CITY, OK

PROJECT NUMBER: 25042
 DRAWING DATE: 09.19.25
 ISSUE DATE: 09.19.25

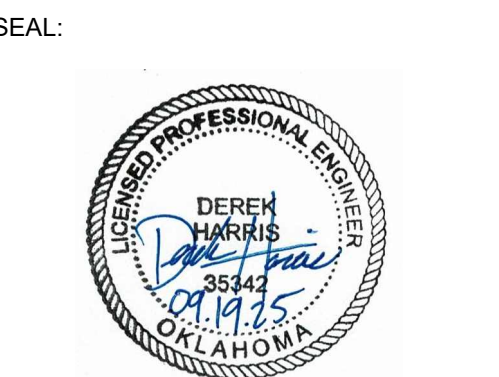

SUBMITTAL:
CONSTRUCTION DRAWINGS

REVISIONS:

MARK	DATE	DESCRIPTION

THESE PLANS AND DRAWINGS ARE NOT TO BE REPRODUCED, CHANGED OR COPIED IN ANY FORM OR MANNER WHATSOEVER WITHOUT FIRST OBTAINING THE WRITTEN PERMISSION AND CONSENT OF CEDAR CREEK CONSULTING INC. THIS SHEET IS NOT TO BE USED FOR CONSTRUCTION UNLESS THE ISSUE DATE IN THE TITLE BLOCK COINCIDES WITH OR POST DATES THE DRAWING DATE. ANY CHANGES MADE FROM THESE PLANS WITHOUT CONSENT OF CEDAR CREEK CONSULTING INC. ARE UNAUTHORIZED AND SHALL RELIEVE CEDAR CREEK CONSULTING OF RESPONSIBILITY FOR ALL CONSEQUENCES ARISING OUT OF SUCH CHANGES.

DRAWING TITLE:
EROSION CONTROL DETAILS

SHEET:
C3.01